

GOVERNORS' ORIENTATION 2023



Housing, Residence Life
and Dining Services

WHY LIVE ON CAMPUS?



*COMMUNITY

*REWARDING



*CHALLENGING

*INDEPENDENCE



*ENJOYABLE

*RESPONSIBILITY

WHAT OUR STUDENTS SAY ABOUT LIVING ON CAMPUS

"Having a meal plan really helps college kids save money"

"Food options are very convenient"

"ACCESS TO RESOURCES ALL THE TIME. BEING IN THE SCHOOL ENVIRONMENT HELPS ME FOCUS ON MY STUDIES MORE"

"A sense of community and total APSU experience"

"Everything important to a student is close. Food, friends, supplies, and the offices"

"Being able to get to my class on time and not having to worry about parking"

WALKING TIMES FROM CENTER OF CAMPUS

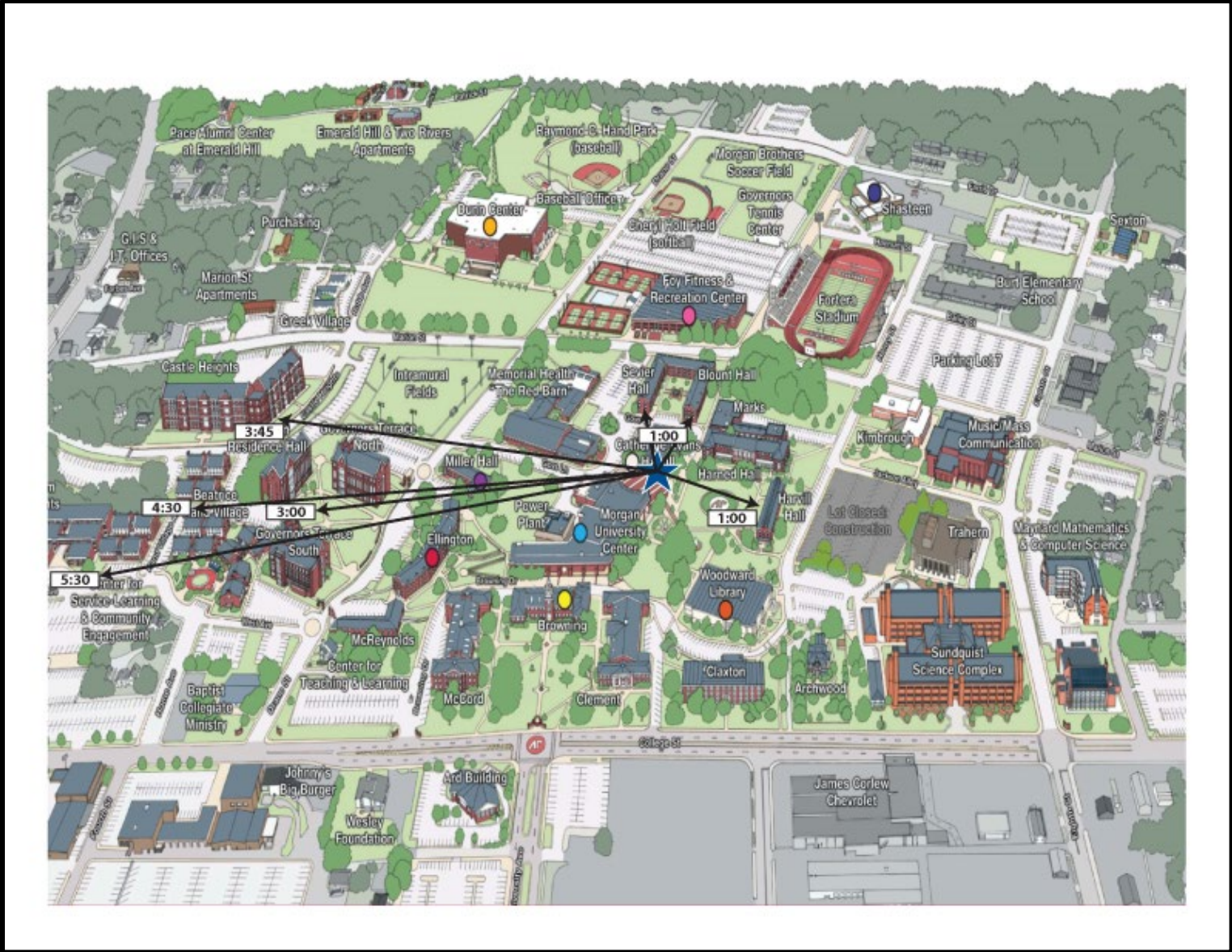

OUR TRADITIONAL RESIDENCE HALLS



Blount Hall

- Male community
- **Singles on 3rd floor.**
- 2 students/room & 4/bath



Harvill Hall

- Co-educational
- **All single rooms.**
- 1 students/room & 2/bath



Sevier Hall

- Female community
- **Singles on 3rd Floor.**
- 2 students/room & 4/bath

OTHER RESIDENCE HALLS



Castle Heights

- Co-educational community
- 2 students/room & bathroom



Govs Terrace North/South

- Co-educational communities
- 2 students/room & bathroom



Eriksson Hall

- Co-educational community
- 2 students/room & bathroom
- On-site dining venue/Terrace

OUR APARTMENT COMPLEXES



HAND VILLAGE

- CO-EDUCATIONAL COMMUNITY
- 4 STUDENTS/APARTMENT
- 4 PRIVATE BEDROOMS AND 2 BATHROOMS



MEACHAM APARTMENTS

- CO-EDUCATIONAL COMMUNITIES
- **300 Building is all singles.**
- 2-4 STUDENTS/APARTMENT
- 2 BEDROOMS AND 1 BATHROOM

OUR APARTMENT COMPLEXES



EMERALD HILL

- CO-EDUCATIONAL COMMUNITY
- 1-3 STUDENTS/APARTMENT
- 1, 1.5, 2, AND 3 BEDROOM OPTIONS
- SHUTTLE SERVICE TO CAMPUS AVAILABLE



TWO RIVERS APARTMENTS

- CO-EDUCATIONAL COMMUNITIES
- 2 STUDENTS/APARTMENT
- 1 BEDROOMS AND 1 BATHROOM
- SHUTTLE SERVICE TO CAMPUS AVAILABLE

GREAT REASONS TO LIVE ON CAMPUS

- **HIGHER GRADES** – STUDENTS WHO LIVE ON CAMPUS ACHIEVE HIGHER GPA'S THAN THOSE WHO COMMUTE. THIS PAST YEAR THE AVERAGE WAS 2.88 CUMULATIVE/CAMPUS-WIDE.
- **FEELING GOOD ABOUT YOURSELF** – STUDENTS ARE MORE LIKELY TO HAVE BETTER POSITIVE SELF IMAGE, ENHANCED SELF CONFIDENCE, PUBLIC SPEAKING ABILITY AND SIMILAR MEASURES OF SELF RELIANCE.
- **PARTICIPATION IN EXTRA CURRICULAR ACTIVITIES** – POTENTIAL EMPLOYERS LOVE THIS!
- **CONVENIENT** – 6 MINUTES FROM ANYTHING ON CAMPUS.

GREAT REASONS TO LIVE ON CAMPUS!

- **NO MONTHLY BILLS** – HOUSING AND MEALS ARE PAID FOR ON A SEMESTER BASIS. YOUR INTERNET, CABLE, LAUNDRY, FURNITURE, WIRELESS ACCESS, IN HOUSE MOVIES/INFORMATION CHANNEL ARE ALL INCLUDED AND NO GAS COSTS FOR YOUR CAR. IT'S ALL INCLUDED IN YOUR HOUSING.
- **SAFETY** – WE HAVE STAFF ON DUTY 365 DAYS A YEAR, 24 HOURS A DAY. RA'S, RHD'S AND CENTRAL OFFICE STAFF ARE THERE FOR YOU. PUBLIC SAFETY OFFICERS ROAM CAMPUS HOUSING DAILY.
- **GREAT COLLEGE EXPERIENCE** – LIVE AND LEARN HERE. GET THAT “EDUCATION OUTSIDE THE CLASSROOM.” LATE NIGHT STUDY GROUPS, PIZZA AT 1 AM, LATE NIGHT TALKS, POSITIVE RELATIONSHIPS WITH OTHERS ALL LEAD TO A WELL ROUNDED STUDENT.
- **NO NEED TO COOK OR CLEAN UP** – GREAT MEALS ARE PREPARED FOR YOU SO NO TIME WASTED SHOPPING FOR GROCERIES, COOKING OR CLEANING DISHES. JUST LIKE HOME.

MENINGITIS IMMUNIZATION REQUIREMENT

- ALL HOUSING STUDENTS MUST HAVE THE MENINGITIS VACCINE. NO RECORDS OLDER THAN 5 YEARS.
- YOU CAN UPLOAD AN OFFICIAL COPY OF YOUR IMMUNIZATION RECORD WITH PROOF OF THE NECESSARY VACCINES AND DATES OR THE [CERTIFICATE OF IMMUNIZATION](#) COMPLETED BY YOUR HEALTHCARE PROVIDER TO THE [APSU ONLINE PORTAL](#). BOYD HEALTH SERVICES.
- MUST HAVE THIS COMPLETE PRIOR TO SIGN UP FOR MOVE IN TIME.
- NO SHOT = NO KEY.



FRESHMAN RESIDENCY REQUIREMENT

- ALL FIRST TIME FRESHMAN WHO ARE NOT MARRIED AND UNDER TWENTY-ONE (21) YEARS OF AGE AND NOT RESIDING WITH THEIR PARENTS OR LEGAL GUARDIAN, MUST LIVE ON CAMPUS FOR THEIR FIRST TWO ACADEMIC SEMESTERS.
- IF YOU WANT TO APPLY FOR AN EXEMPTION FROM THIS REQUIREMENT, THE FORM IS ONLINE AT THE HOUSING WEBPAGE.

[HTTPS://WWW.APSU.EDU/HOUSING/FUTURE-RESIDENTS/RESIDENCY-EXEMPTION-FORM.PHP](https://www.apsu.edu/housing/future-residents/residency-exemption-form.php)

AMENITIES

- MONTHLY PAYMENT PLANS
- ONE PAYMENT...ALL INCLUSIVE.
- 10 MONTH HOUSING CONTRACT- WINTER BREAK-STAY
- FREE LAUNDRY – NO QUARTERS NEEDED
- LOBBIES, KITCHENS AND STUDY ROOMS
- INTERNET SERVICES/WIRELESS- TV SERVICE
- MAINTENANCE SERVICES/WORK ORDERS
- DESIGNATED RESIDENTIAL PARKING
- STAFFING FOR ASSISTANCE
- CARD READERS FOR ACCESS



STAFF: RESIDENT HALL DIRECTORS & RESIDENT ASSISTANTS

- **PROFESSIONAL STAFF (AREA COORDINATORS)**
- **ROUGHLY 70 STUDENT WORKERS (RHDS & RAS)**
- **ALL OF THE STAFF LIVE ON CAMPUS AND SOMEONE IS ON CALL 24/7 FOR EMERGENCIES.**
- **PROGRAMMING OPPORTUNITIES/LEADERSHIP.**

RULES AND REGULATIONS

- ALL APARTMENTS ARE SMOKE-FREE
- ZERO TOLERANCE ON DRUGS
- PARKING
- NO ALCOHOL/DRY CAMPUS
- NO PETS (EXCEPTIONS: SERVICE ANIMALS AND FISH IN 20 GALLON TANK OR SMALLER)
- VISITATION
- SAFETY – USING ONE CARD ACCESS ENTRANCE, LOCKING YOUR DOOR, WALKING ALONE, USING YOUR PEEP HOLE
- HEALTH AND SAFETY CHECKS

RENTAL INSURANCE

- A. PROPERTY – THE UNIVERSITY WILL BE HELD HARMLESS FROM ANY SUIT ACTION AT LAW, OR OTHER CLAIM WHATSOEVER RESULTING FROM OR ARISING OUT OF DAMAGE OR THEFT OF PROPERTY WHILE THE STUDENT IS THE OCCUPANT OF THE RESIDENCE HALL UNDER THIS AGREEMENT EXCEPT WHERE DAMAGE OR THEFT IS DUE TO THE NEGLIGENCE OF THE UNIVERSITY OR ITS EMPLOYEES.
 - CHECK HOME OWNERS INSURANCE/RENTERS INSURANCE
 - INVENTORY ITEMS

WHAT YOU WILL NEED TO BRING

- LINEN - EXTRA LONG TWIN
- 3M COMMAND STRIPS (FOR HANGING PICTURES, ETC.)
- TOILETRIES
- HEAD/EAR PHONES FOR ELECTRONICS
- EXTENSION CORDS WITH POWER STRIPS
- EATING UTENSILS
- DESK LAMP
- CLOTHES HANGERS
- LAUNDRY SUPPLIES
- ETHERNET CORD FOR COMPUTERS/LAPTOPS – 6 FT



WHAT NOT TO BRING

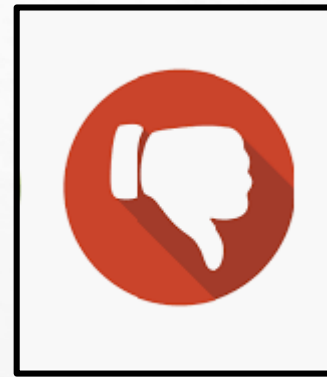

- CANDLES/INCENSE
- HOT POTS/ELECTRIC FRY PANS
- SPACE HEATERS
- WATERBEDS
- BED RISERS
- DART BOARDS
- INDUSTRIAL STRENGTH STEREOS
- EXPENSIVE JEWELRY/COLLECTIBLES
- AMPLIFIED INSTRUMENTS
- FIRE ARMS, HUNTING KNIVES, MARTIAL ARTS EQUIPMENT
- MICROWAVES WITH POWER GREATER THAN 1 000 WATTS
- REFRIGERATORS LARGER THAN 5.0 CUBIC FEET



ROOM ASSIGNMENTS

- WEB-BASED* YOU PICK YOUR OWN ROOM.
- BASED ON AVAILABILITY
- IN-HALL CHANGES- FIRST WEEK OF SEMESTER.
- GREAT CHANGE DAY
- CHECK YOUR APSU STUDENT EMAIL ACCOUNT OFTEN! THIS IS HOW APSU COMMUNICATES IMPORTANT INFORMATION TO YOU!

***A PREPAYMENT OF \$100 MUST BE PROCESSED BEFORE YOUR ROOM AND MEAL PLAN ARE CONFIRMED FOR ACADEMIC YEAR.**



Housing License Agreement

Austin Peay State University
LICENSE AGREEMENT FOR UNIVERSITY HOUSING
Office of Housing/Residence Life and Dining Services
Phone: (931) 221-7444 Fax: (931) 221-7165

- Academic year Contract

I. LICENSE AGREEMENT PERIOD

A. Academic Year (August 2023 - May 2024)

B. Spring Semester Only (January 2024 - May 2024)
Occupancy of the residence hall room will be for the above period of time. It will extend from the announced opening of the residence halls until 24 hours after the students last final exam. For graduating seniors, occupancy in the residence halls may be extended until 10 a.m. on the day after the graduation ceremony. The term of this agreement will begin on the weekend (see current rate schedule for specific dates and times) prior to the day of move in for the specified fall term and will remain in effect until the day of the Student's last spring term examination or spring graduation date if the Student is among those "Students" scheduled, in advance, to graduate.

A. Academic Year Terms - Student agrees to reside on campus for both the fall and spring terms, provided 'Student' enrolls in 'University' for both terms. Fall housing fees are due and must be paid during the fee payment period at the beginning of the fall term. Spring housing fees are due and must be paid during the fee payment period at the beginning of the spring term.

B. Spring Term only- Student who enrolls for spring term only.

II. TERMINATION OF LICENSE AGREEMENT

A. BY THE STUDENT - A request for the termination of this agreement must be made in writing to the Office of Housing/Residence Life and Dining Services no later than May 1 if applying for the academic year, or no later than December 1 if applying for the spring semester in order to receive a full refund of prepayment. CANCELLATION AFTER THESE DEADLINES WILL RESULT IN FORFEITURE OF PRE-PAYMENT, APPLICATIONS AND /OR PREPAYMENTS MAY NOT BE TRANSFERRED.

B. BY THE UNIVERSITY - This agreement shall terminate at the discretion of the Office of Housing/Residence Life and Dining Services in the event of any of the following:

1. The premises are destroyed, or in the opinion of the Office of Housing/Residence Life and Dining Services, are unsuitable for occupancy for any other reason.
2. The student fails to fulfill financial obligations specified in this University Housing/Residence Life policy, or if the student for any reason loses status as an enrolled student. In such circumstances, the student will be given 24 hours to vacate the premises.
3. The student is not accepted to the University. In such cases, the student will be charged a daily rate for occupancy in the residence halls/apartments.
4. Other extenuating circumstances whereby the student is given thirty (30) days notice in writing by the Office of Housing/Residence Life and Dining Services.

C. ABANDONMENT OF PROPERTY - In the event the student abandons personal property, The Office of Housing/Residence Life and Dining Services will attempt to contact the student. If the Housing Office is unable to contact the student, the materials will be inventoried and stored for a period of time not to exceed thirty (30) days, during which the student will be charged a daily storage fee. The University assumes no liability for any stored items. At the end of the thirty (30) day waiting period, all stored items will be disposed of properly.

D. ENROLLMENT STATUS- Student must be enrolled as a student of the University to reside on campus.

III. PAYMENT OF RENT

Payment of rent for the particular housing to which the student has been assigned is due on a semester basis, at or prior to registration.

IV. REFUND POLICIES

A. RENT

1. Contingent upon an approved Request for Release from License Agreement for Illness or Other Health Related Reason by University Housing by Housing/Residence Life and Dining Services, a pro-rated refund will be made if a student moves out of the residence halls/apts due to personal illness, (confirmed in writing by a licensed physician) OR at the request of the University for other than disciplinary reasons (i.e., marriage, academic suspension).
2. A percentage refund of rent will be made if the student is forced to move out of University housing due to withdrawal from the University. This percentage refund will be the same as the percentage refund policy for general maintenance fees (see Undergraduate/Graduate Bulletin).
3. No refund of rent will be made if the student moves out of the residence halls for any other reason except those noted in 1 and 2 above.

B. PRE-PAYMENT

The prepayment will be refunded if:

1. The student cancels the license agreement by May 1 for the academic year. For all new students applying for Spring Semester, the DEADLINE for cancellation is December 1. APPLICATIONS SUBMITTED AFTER THESE DATES WILL BE SUBJECT TO AUTOMATIC FORFEITURE OF HOUSING PREPAYMENT UPON CANCELLATION.
2. The inability of the student to move into University housing due to lack of space.
3. The student is not accepted to APSU. (Verified by Admissions Office).
4. The student is deceased.

VI. USE OF FACILITIES

- A. STANDARDS - The student will exercise reasonable care for and maintain acceptable standards of cleanliness in the assigned room and adjoining bathroom.
- B. HOUSING RULES AND REGULATIONS - The student will abide by all rules and regulations pertaining to residency in University housing as set forth in the Residence Life Handbook.
- C. CODE OF CONDUCT - The student will abide by the APSU Student Code of Conduct.
- D. DAMAGE - The student is responsible for the assigned room and its contents and will be charged for any and all damage occurring during the term of occupancy. Students who damage university property through negligence or willful actions will be financially liable and subject to disciplinary action. If the identity of the person cannot be determined, the cost of the repair may be divided among all or any portion of the residents of the hall.

VII. UNIVERSITY LIABILITY

- A. PROPERTY - The University will be held harmless from any suit, action at law, or other claim whatsoever resulting from or arising out of damage or theft of property while the student is the occupant of the residence hall under this agreement except where damage or theft is due to the negligence of the University or its employees.
- B. PERSONAL INJURY - The University will not be held liable for any injuries in the residence halls or grounds unless the injury is due to the negligence of the University or its employees.
- C. DISRUPTION OF SERVICE - The University will not be liable for the disruptions to any services that are beyond the University's control and that are restored within a reasonable amount of time.
- D. ASSIGNMENTS - The University reserves the right to the assignments or reassignments of residence hall spaces. The University reserves the right to deny assignment to any student.
- E. ROOM ENTRY - The University reserves the right for authorized University personnel to enter the student's room for any purpose connected with the maintenance, housekeeping, or for any other reason reasonably connected with the interest of the University or the enforcement of rules and regulations.

VIII. MEAL PLAN

A. REQUIRED - Each Housing Student is required to participate in a meal plan offered by the University dining program. By participation in the meal plan, the student agrees to accept meal plan agreement. Only exception is for residents of Two Rivers and Emerald Hill (non-traditional/family housing).

VIRTUAL TOURS & FLOOR PLANS

- CAN BE VIEWED ON THE APSU HOUSING, RESIDENCE LIFE & DINING SERVICES WEBSITE.
- EXAMPLE OF A CASTLE HEIGHTS FLOOR PLAN BELOW:

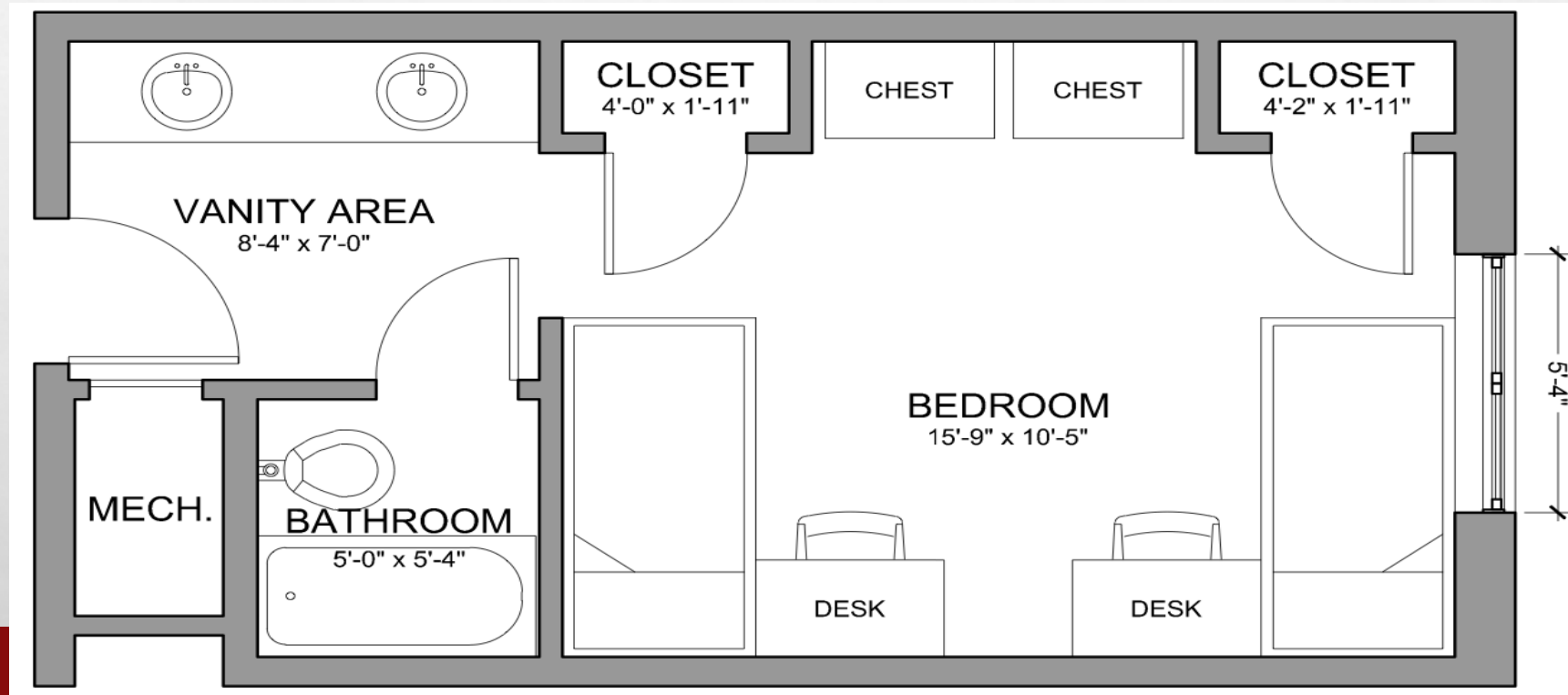

WANT AN IN-PERSON TOUR?

- ALL TOURS ARE CONDUCTED BY OUR ADMISSIONS OFFICE, PLEASE SIGN UP AT [APSU.EDU/TOUR](https://apsu.edu/tour) OR CALL THE ADMISSIONS OFFICE AT 931-221-7661.
- YOU WILL GET AN ENTIRE CAMPUS TOUR ALONG WITH OUR SHOW ROOMS WHICH ARE LOCATED IN CASTLE HEIGHTS AND SEVIER HALL.



DINING SERVICES

- ALL RESIDENTS MUST HAVE A MEAL PLAN EACH SEMESTER (EXCEPTION- TWO RIVERS AND EMERALD HILL APTS)
- FRESHMAN CAN SELECT FROM THE **GOVS' CHOICE (Unlimited), 14 PLUS, OR 10 PLUS PLANS**
- MEAL EXCHANGES- \$7 VALUE
- MEALS ARE NON-TRANSFERABLE
- PLUS DOLLARS ROLLOVER FROM FALL TO SPRING SEMESTER
- 14 DIFFERENT DINING OPTIONS ON CAMPUS
- VISIT OUR HOUSING WEBSITE TO VIEW
 - FULL MEAL PLAN AGREEMENT
 - SODEXO (DINING CONTRACTOR) WEBSITE
 - IMPORTANT DATES REGARDING MEAL PLAN CHANGES





MEAL PLANS AVAILABLE

RESIDENT MEAL PLANS/FRESHMAN

GOVS CHOICE/UNLIMITED	\$350 DINING DOLLARS	\$2455
14 MEAL PLAN	\$350 DINING DOLLARS	\$2290
10 MEAL PLAN	\$400 DINING DOLLARS	\$2055

MEAL PLANS NON FRESHMAN

\$1115 DINING DOLLARS	\$1115
\$750 DINING DOLLARS	\$750



THE CAF

HOUSING RATES FOR 23-24

- BLOUNT, HARVILL, SEVIER
\$3370/SEMESTER
- TWO RIVERS, MEACHAM \$3415/SEMESTER
- CASTLE HEIGHTS, ERIKSSON, GOVS TERRACE
NORTH AND SOUTH \$3985/SEMESTER
- HAND VILLAGE \$4110/SEMESTER
- EMERALD HILL- \$3590-\$4080/SEMESTER



MOVE IN DATES FOR THE FALL SEMESTER

● **AUGUST 23-26.** BY RESIDENCE HALL



● EMAIL TO STUDENT ACCT TO SIGN UP FOR CHECK IN TIME.

LABEL ALL BOXES AND CARTONS

TWO WHEELED DOLLY MIGHT BE HELPFUL

DON'T BRING EVERYTHING YOU OWN

FINAL THOUGHTS



- EMERGENCY CONTACT CARD
- REMEMBER TO STAY INVOLVED IN YOUR FAMILY MEMBER'S LIVES WHILE IN COLLEGE – EMAIL LETTERS, PHONE CALLS, ETC. VISITS TO CAMPUS. CALL FIRST!
- LET US KNOW IF YOU NEED ANYTHING. FIRST, TELL YOUR STUDENT TO TAKE RESPONSIBILITY AND HANDLE IT THEMSELVES. WORK ORDERS, ETC. IF NO ACTION, GIVE US A CALL.

QUESTIONS OR COMMENTS? HOUSING, RESIDENCE LIFE & DINING SERVICES

- LOCATION: MILLER HALL, ROOM 121
- MAIN OFFICE: 931-221-7444
- EMAIL HOUSING@APSU.EDU
- MAILING ADDRESS: P.O. BOX 4596, CLARKSVILLE, TN 37044
- SUMMER OFFICE HOURS: MON – FRI, 8:00 AM – 4:30 PM
- FACEBOOK – AUSTIN PEAY HOUSING RESIDENCE LIFE AND DINING SERVICES



facebook